

SIEMENS

Product data sheet

3RV1021-1KA10



Abb. ähnlich / similar picture

CIRCUIT-BREAKER SIZE S0,
FOR MOTOR PROTECTION, CLASS 10,
A-REL. 9...12.5A,
N-REL. 163A SCREW TERMINAL,
STANDARD SWITCHING CAPACITY

General technical details:

Continuous current / rated value	12.5 A
Adjustable response current	
<ul style="list-style-type: none"> • of the non-delayed short-circuit release <ul style="list-style-type: none"> • initial value • final value • of the current-dependent overload release <ul style="list-style-type: none"> • initial value • final value 	163 A 163 A 9 A 12.5 A
Switch-off capacity limit short-circuit current / at 400 V / rated value	100 kA
Type of voltage	AC/DC
Service power	
<ul style="list-style-type: none"> • at AC-3 / at 400 V / rated value • for three-phase servomotors / rated value 	5.5 kW 5.5 kW
Number of poles	3
Number of NC contacts / for auxiliary contact	0
Number of NO contacts / for auxiliary contact	0
Number of change-over switches / for auxiliary contact	0

Trip class	CLASS 10
Product function / Overload protection	Yes
Mechanical design:	
Design of the electrical connection / for main current circuit	screw-type terminals
Type of fixing/fixation	screw and snap-on mounting onto 35 mm standard mounting rail according to DIN EN 50022
Product component / auxiliary switch	No
Size of the circuit-breaker	S0
Ambient conditions:	
Protection class IP	IP20

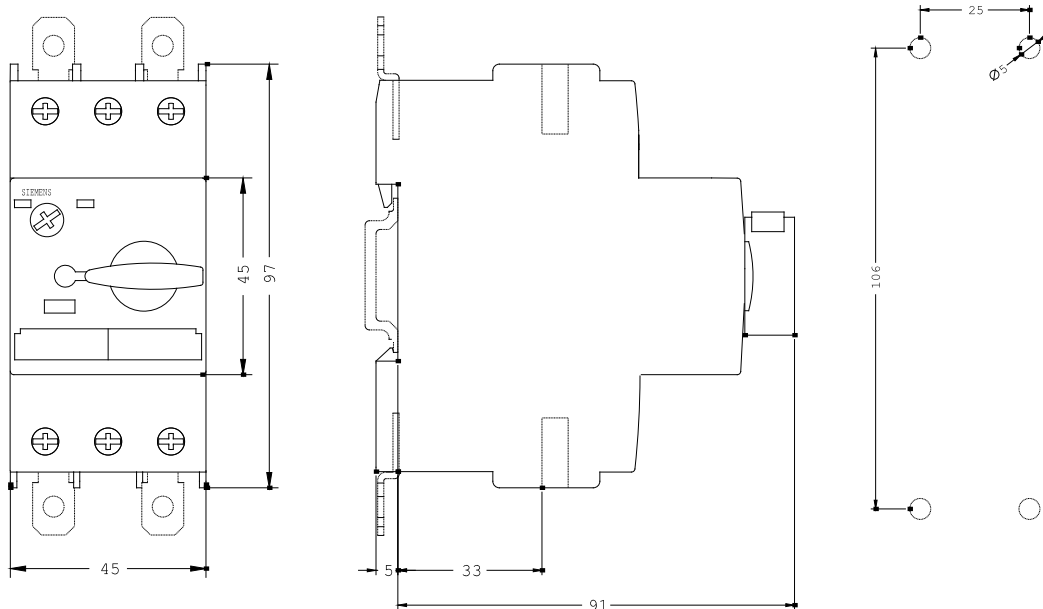

last change:

11/02/2006

Technical Assistance:	Telephone:	+49 (0) 911-895-5900 (8°° - 17°° CET)
	Fax:	+49 (0) 911-895-5907
	E-Mail:	technical-assistance@siemens.com
	Internet:	www.siemens.de/lowvoltage/technical-assistance