

SIEMENS

Product data sheet

3RV1021-4AA10



Abb. ähnlich / similar picture

CIRCUIT-BREAKER SIZE S0,
FOR MOTOR PROTECTION, CLASS 10,
A-REL. 11...16A, N-REL. 208A,
SCREW TERMINAL,
STANDARD SWITCHING CAPACITY

General technical details:

| | |
|---|--------------------------------|
| Continuous current / rated value | 16 A |
| Adjustable response current | |
| <ul style="list-style-type: none"> • of the non-delayed short-circuit release <ul style="list-style-type: none"> • initial value • final value • of the current-dependent overload release <ul style="list-style-type: none"> • initial value • final value | 208 A 208 A 11 A 16 A |
| Switch-off capacity limit short-circuit current / at 400 V / rated value | 50 kA |
| Type of voltage | AC/DC |
| Service power | |
| <ul style="list-style-type: none"> • at AC-3 / at 400 V / rated value • for three-phase servomotors / rated value | 7.5 kW 7.5 kW |
| Number of poles | 3 |
| Number of NC contacts / for auxiliary contact | 0 |
| Number of NO contacts / for auxiliary contact | 0 |
| Number of change-over switches / for auxiliary contact | 0 |

| | |
|--|--|
| Trip class | CLASS 10 |
| Product function / Overload protection | Yes |
| Mechanical design: | |
| Design of the electrical connection / for main current circuit | screw-type terminals |
| Type of fixing/fixation | screw and snap-on mounting onto 35 mm standard mounting rail according to DIN EN 50022 |
| Product component / auxiliary switch | No |
| Size of the circuit-breaker | S0 |
| Ambient conditions: | |
| Protection class IP | IP20 |

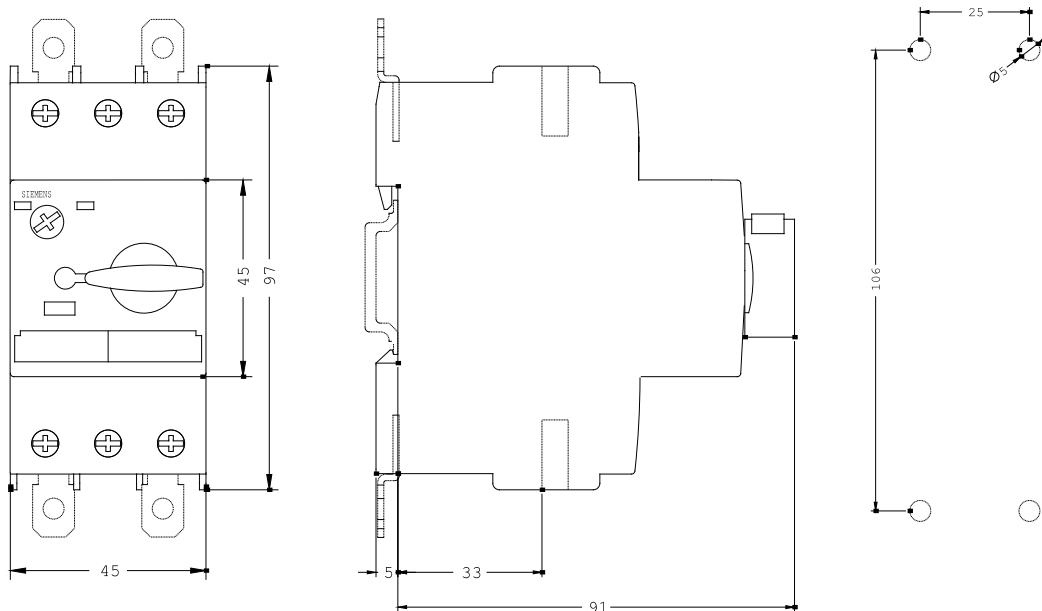

last change:

11/02/2006

| | | |
|------------------------------|------------|--|
| Technical Assistance: | Telephone: | +49 (0) 911-895-5900 (8°° - 17°° CET) |
| | Fax: | +49 (0) 911-895-5907 |
| | E-Mail: | technical-assistance@siemens.com |
| | Internet: | www.siemens.de/lowvoltage/technical-assistance |