

SIEMENS

Product data sheet

3RV1031-4AA10



Abb. ähnlich / similar picture

CIRCUIT-BREAKER 11...16 A,
N-RELEASE 208 A, SIZE S2,
MOTOR PROTECTION CLASS 10 SCREW
CONNECTION STANDARD BREAKING CAPACITY

General technical details:

Continuous current / rated value	16 A
Adjustable response current	
• of the non-delayed short-circuit release	
• initial value	208 A
• final value	208 A
• of the current-dependent overload release	
• initial value	11 A
• final value	16 A
Switch-off capacity limit short-circuit current / at 400 V / rated value	50 kA
Type of voltage	AC/DC
Service power	
• at AC-3 / at 400 V / rated value	7.5 kW
• for three-phase servomotors / rated value	7.5 kW
Number of poles	3
Number of NC contacts / for auxiliary contact	0
Number of NO contacts / for auxiliary contact	0
Number of change-over switches / for auxiliary contact	0

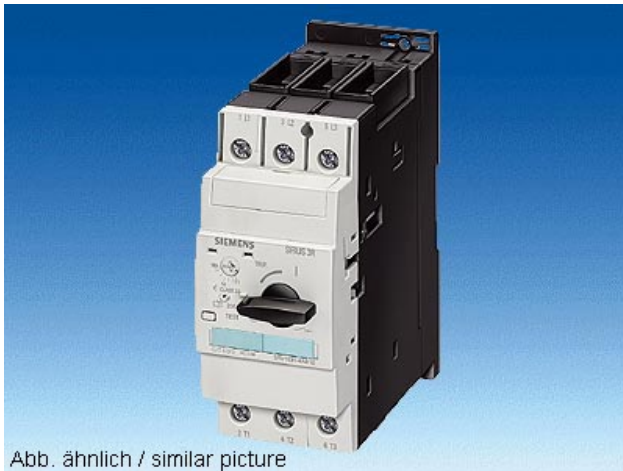
Trip class	CLASS 10
Product function / Overload protection	Yes
Mechanical design:	
Design of the electrical connection / for main current circuit	screw-type terminals with box terminals
Type of fixing/fixation	screw and snap-on mounting onto 35 mm standard mounting rail according to DIN EN 50022
Product component / auxiliary switch	No
Size of the circuit-breaker	S2
Ambient conditions:	
Protection class IP	IP20

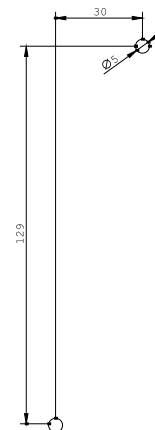
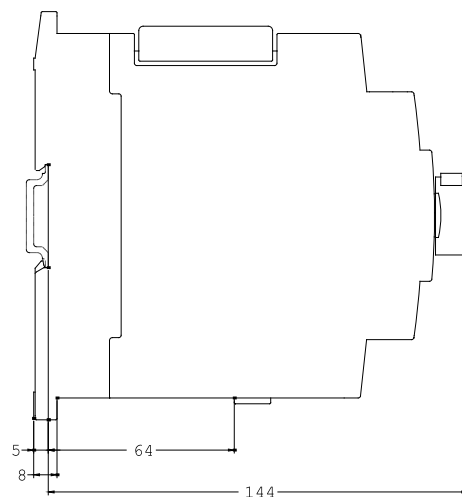
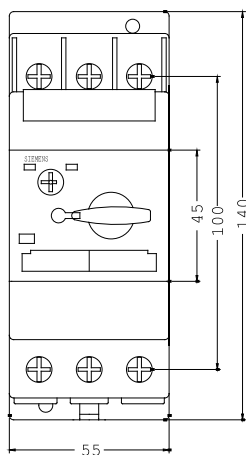

last change:

11/02/2006

Technical Assistance:

Telephone: +49 (0) 911-895-5900 (8° - 17° CET)

Fax: +49 (0) 911-895-5907

E-Mail: technical-assistance@siemens.comInternet: www.siemens.de/lowvoltage/technical-assistance