

# SIEMENS

## Product data sheet

## 3RV1031-4EA10



Abb. ähnlich / similar picture

CIRCUIT-BREAKER SIZE S2. FOR MOTOR PROTECTION, CLASS 10, A-REL. 22...32A, N-REL. 416A, SCREW TERMINAL, STANDARD SWITCHING CAPACITY

### General technical details:

Continuous current / rated value	32 A
Adjustable response current	
<ul style="list-style-type: none"> <li>• of the non-delayed short-circuit release           <ul style="list-style-type: none"> <li>• initial value</li> <li>• final value</li> </ul> </li> <li>• of the current-dependent overload release           <ul style="list-style-type: none"> <li>• initial value</li> <li>• final value</li> </ul> </li> </ul>	416 A 416 A 22 A 32 A
Switch-off capacity limit short-circuit current / at 400 V / rated value	50 kA
Type of voltage	AC/DC
Service power	
<ul style="list-style-type: none"> <li>• at AC-3 / at 400 V / rated value</li> <li>• for three-phase servomotors / rated value</li> </ul>	15 kW 15 kW
Number of poles	3
Number of NC contacts / for auxiliary contact	0
Number of NO contacts / for auxiliary contact	0
Number of change-over switches / for auxiliary contact	0

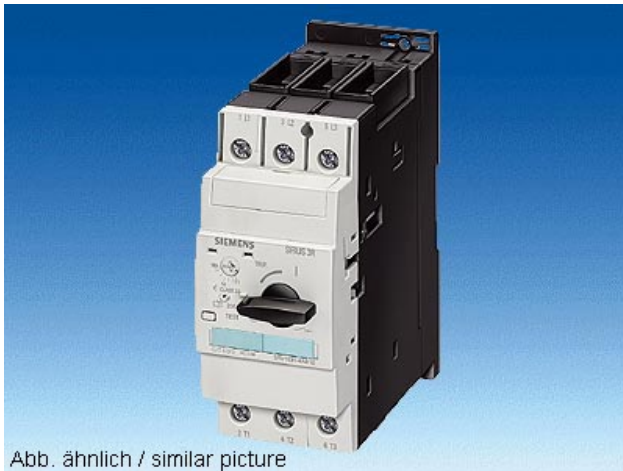
Trip class	CLASS 10
Product function / Overload protection	Yes
<b>Mechanical design:</b>	
Design of the electrical connection / for main current circuit	screw-type terminals with box terminals
Type of fixing/fixation	screw and snap-on mounting onto 35 mm standard mounting rail according to DIN EN 50022
Product component / auxiliary switch	No
Size of the circuit-breaker	S2
<b>Ambient conditions:</b>	
Protection class IP	IP20

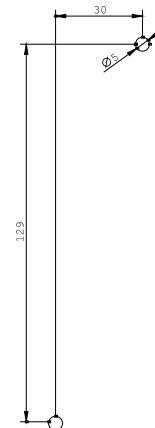
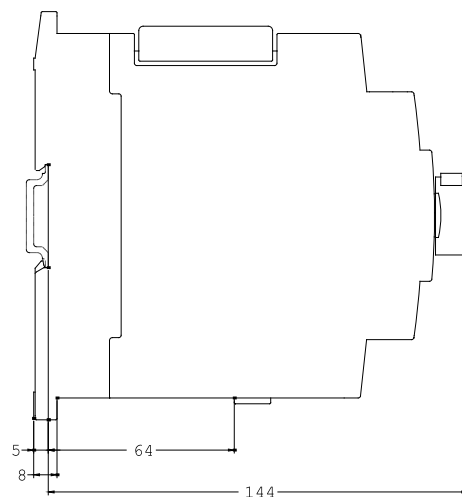
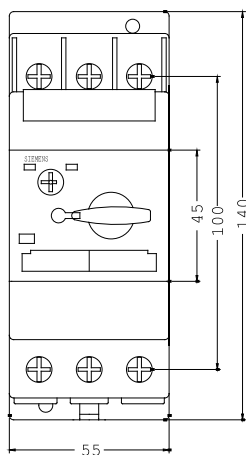

last change:

11/02/2006

**Technical Assistance:**

Telephone: +49 (0) 911-895-5900 (8° - 17° CET)

Fax: +49 (0) 911-895-5907

E-Mail: [technical-assistance@siemens.com](mailto:technical-assistance@siemens.com)Internet: [www.siemens.de/lowvoltage/technical-assistance](http://www.siemens.de/lowvoltage/technical-assistance)