

SIEMENS

Product data sheet

3RW3025-1AB14



SIRIUS CUSHIONED STARTER, SIZE S0,
16 A, 7.5 KW / 400 V, AC 200...460 V,
UC 110...230 V, SCREW CONNECTION

Power Electronics:

Product designation	soft starters for standard applications
Operating current	
<ul style="list-style-type: none"> • at 40 °C / rated value 	16 A
<ul style="list-style-type: none"> • at 50 °C / rated value 	14 A
<ul style="list-style-type: none"> • at 60 °C / rated value 	12 A
Emitted mechanical power / for three-phase servomotors	
<ul style="list-style-type: none"> • at 230 V / at standard switching / at 40 °C <ul style="list-style-type: none"> • rated value 	4000 W
<ul style="list-style-type: none"> • at 400 V / at standard switching / at 40 °C <ul style="list-style-type: none"> • rated value 	7500 W
Yielded mechanical performance (hp) / for three-phase servomotors	
<ul style="list-style-type: none"> • at 200 V / at standard switching <ul style="list-style-type: none"> • at 50 °C / rated value 	3 hp
<ul style="list-style-type: none"> • at 230 V / at standard switching <ul style="list-style-type: none"> • at 50 °C / rated value 	3 hp
<ul style="list-style-type: none"> • at 460 V / at standard switching <ul style="list-style-type: none"> • at 50 °C / rated value 	10 hp

Operating voltage	
• rated value	
• minimum	200 V
• maximum	460 V
Operating frequency	
• rated value	
• minimum	50 Hz
• maximum	60 Hz
Control electronics:	
Control supply voltage	
• at 50 Hz / for AC / rated value	
• minimum	110 V
• maximum	230 V
• at 60 Hz / for AC / rated value	
• minimum	110 V
• maximum	230 V
• for DC / rated value	
• minimum	110 V
• maximum	230 V
Supply voltage frequency / for auxiliary and control current circuit / rated value	
• minimum	50 Hz
• maximum	60 Hz
Type of voltage	AC/DC
Mechanical design:	
Size of the engine control device	S0
Width	45 mm
Height	125 mm
Depth	124 mm
Number of poles	3
Type of fixing/fixation	screw and snap-on mounting
Electrical connections:	
Design of the electrical connection	
• for main current circuit	screw-type terminals

• for auxiliary and control current circuit	screw-type terminals
Number of NC contacts	0
Number of NO contacts	2
Number of change-over switches	0
Ambient conditions:	
Ambient temperature	-25 °C
Ambient temperature	60 °C
Protection class IP	IP20
General details:	
Equipment identification	Q
Equipment identification	G

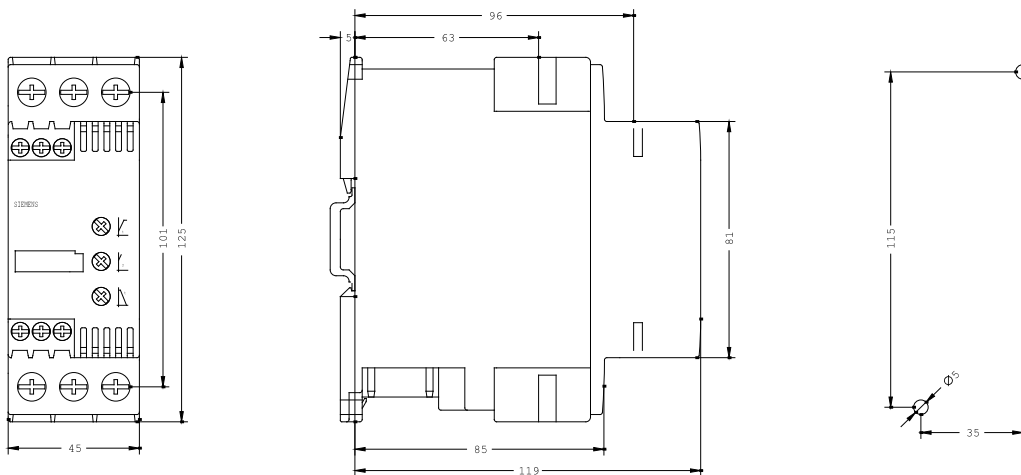

last change:

10/31/2006

Technical Assistance:	Telephone:	+49 (0) 911-895-5900 (8°° - 17°° CET)
	Fax:	+49 (0) 911-895-5907
	E-Mail:	technical-assistance@siemens.com
	Internet:	www.siemens.de/lowvoltage/technical-assistance