

SIEMENS

Product data sheet

3RW3026-1AB14



SIRIUS CUSHIONED STARTER, SIZE S0,
25 A, 11 KW / 400 V, AC 200...460 V,
UC 110...230 V, SCREW CONNECTION

Power Electronics:

Product designation	soft starters for standard applications
---------------------	---

Operating current

- | | |
|--|-------------------------------------|
| <ul style="list-style-type: none"> • at 40 °C / rated value • at 50 °C / rated value • at 60 °C / rated value | <p>25 A</p> <p>21 A</p> <p>18 A</p> |
|--|-------------------------------------|

Emitted mechanical power / for three-phase servomotors

- | | |
|---|--|
| <ul style="list-style-type: none"> • at 230 V / at standard switching / at 40 °C | |
|---|--|

<ul style="list-style-type: none"> • rated value 	5500 W
<ul style="list-style-type: none"> • at 400 V / at standard switching / at 40 °C 	
<ul style="list-style-type: none"> • rated value 	11000 W
Yielded mechanical performance (hp) / for three-phase servomotors	
<ul style="list-style-type: none"> • at 200 V / at standard switching 	
<ul style="list-style-type: none"> • at 50 °C / rated value 	5 hp
<ul style="list-style-type: none"> • at 230 V / at standard switching 	
<ul style="list-style-type: none"> • at 50 °C / rated value 	5 hp
<ul style="list-style-type: none"> • at 460 V / at standard switching 	
<ul style="list-style-type: none"> • at 50 °C / rated value 	15 hp
Operating voltage	
<ul style="list-style-type: none"> • rated value 	
<ul style="list-style-type: none"> • minimum 	200 V
<ul style="list-style-type: none"> • maximum 	460 V
Operating frequency	
<ul style="list-style-type: none"> • rated value 	
<ul style="list-style-type: none"> • minimum 	50 Hz
<ul style="list-style-type: none"> • maximum 	60 Hz
Control electronics:	
Control supply voltage	
<ul style="list-style-type: none"> • at 50 Hz / for AC / rated value 	
<ul style="list-style-type: none"> • minimum 	110 V
<ul style="list-style-type: none"> • maximum 	230 V
<ul style="list-style-type: none"> • at 60 Hz / for AC / rated value 	
<ul style="list-style-type: none"> • minimum 	110 V
<ul style="list-style-type: none"> • maximum 	230 V
<ul style="list-style-type: none"> • for DC / rated value 	
<ul style="list-style-type: none"> • minimum 	110 V
<ul style="list-style-type: none"> • maximum 	230 V
Supply voltage frequency / for auxiliary and control current circuit / rated value	
<ul style="list-style-type: none"> • minimum 	50 Hz
<ul style="list-style-type: none"> • maximum 	60 Hz
Type of voltage	AC/DC

Mechanical design:	
Size of the engine control device	S0
Width	45 mm
Height	125 mm
Depth	124 mm
Number of poles	3
Type of fixing/fixation	screw and snap-on mounting
Electrical connections:	
Design of the electrical connection	
<ul style="list-style-type: none"> • for main current circuit • for auxiliary and control current circuit 	screw-type terminals screw-type terminals
Number of NC contacts	0
Number of NO contacts	2
Number of change-over switches	0
Ambient conditions:	
Ambient temperature	-25 °C
Ambient temperature	60 °C
Protection class IP	IP20
General details:	
Equipment identification	Q
Equipment identification	G

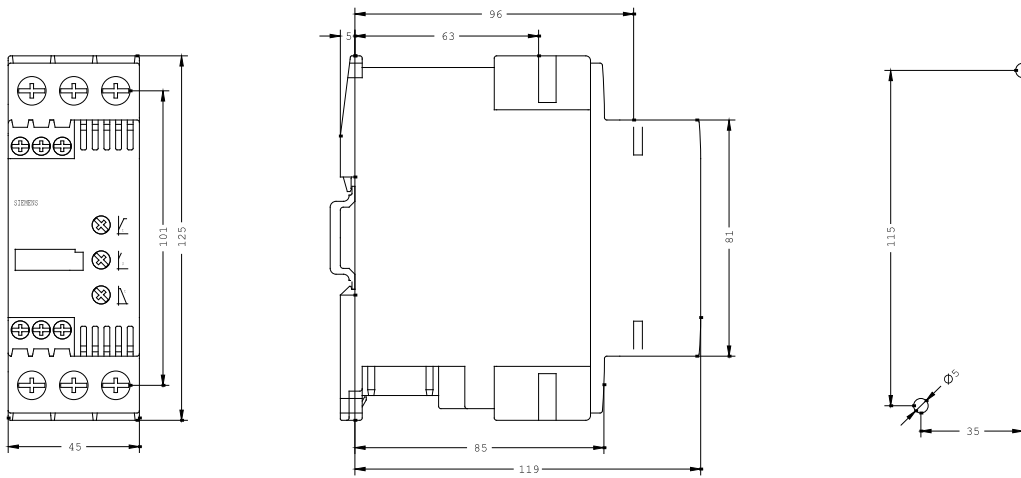

last change:

10/31/2006

Technical Assistance:

Telephone: +49 (0) 911-895-5900 (8⁰⁰ - 17⁰⁰ CET)

Fax: +49 (0) 911-895-5907

E-Mail: technical-assistance@siemens.com

Internet: www.siemens.de/lowvoltage/technical-assistance