

# SIEMENS

## Product data sheet

## 3RT1035-1AB00-1AA0



Abb. ähnlich / similar picture

CONTACTOR, AC-3 18.5 KW/400 V, AC 24 V,  
50 HZ, 3-POLE, SIZE S2,  
SCREW CONNECTION MOUNTING POSITION  
VERTICAL

### General details:

|                       |    |
|-----------------------|----|
| Size of the contactor | S2 |
| Number of poles       | 3  |

### Control circuit:

|  |              |
|--|--------------|
| Design of activation of the operating mechanism                                    | conventional |
| Type of voltage  | AC           |
| Control supply voltage   |              |
| • at 50 Hz / for AC / rated value / minimum  | 24 V         |
| • at 50 Hz / for AC / rated value / maximum  | 24 V         |
| Supply voltage frequency / for auxiliary and control current circuit / rated value |              |
| • minimum  | 50 Hz        |
| • maximum  | 50 Hz        |

### Main circuit:

|   |      |
|---|------|
| Number of NC contacts / for main contacts | 0    |
| Number of NO contacts / for main contacts | 3    |
| Operating current                         |      |
| • at AC-3 / at 400 V / rated value        | 40 A |
| • at AC-1 / at 400 V / rated value        | 60 A |

|   |  |
|---|--|
| Service power   |  |
| • at AC-3 / at 400 V / rated value  | 18.5 kW  |
| • at AC-1 / at 400 V / rated value  | 38 kW  |
| <b>Auxiliary circuit:</b>   |  |
| Number of NO contacts / for auxiliary contact                                   | 0  |
| Number of NC contacts / for auxiliary contact                                   | 0  |
| <b>Connection type:</b>   |  |
| Design of the electrical connection / for main current circuit                  | screw-type terminals   |
| Design of the electrical connection / for auxiliary and control current circuit | screw-type terminals   |
| <b>Mounting/fixing:</b>   |  |
| Type of fixing/fixation   | screw and snap-on mounting onto 35 mm standard mounting rail according to DIN EN 50022 |
| Series installation   | Yes  |

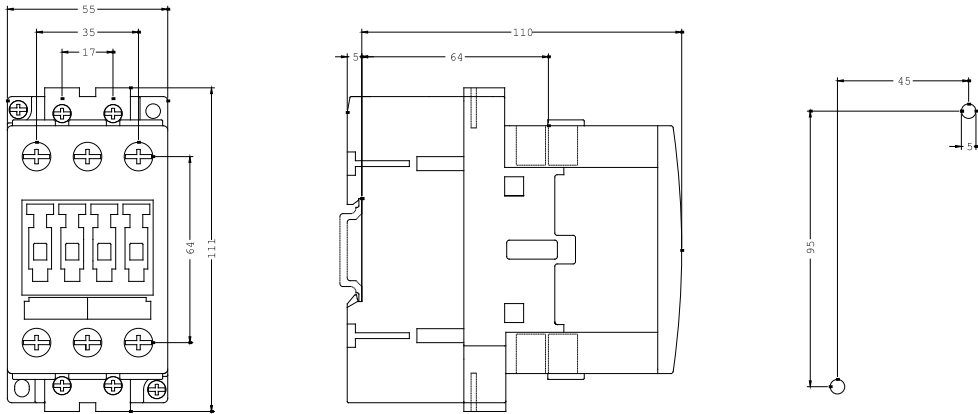

last change:

10/31/2006

|                              |            |  |
|------------------------------|------------|--|
| <b>Technical Assistance:</b> | Telephone: | +49 (0) 911-895-5900 (8°° - 17°° CET)  |
|                              | Fax:       | +49 (0) 911-895-5907   |
|                              | E-Mail:    | technical-assistance@siemens.com   |
|                              | Internet:  | <a href="http://www.siemens.de/lowvoltage/technical-assistance">www.siemens.de/lowvoltage/technical-assistance</a> |