

SIEMENS

Product data sheet

3RT1055-6AB36

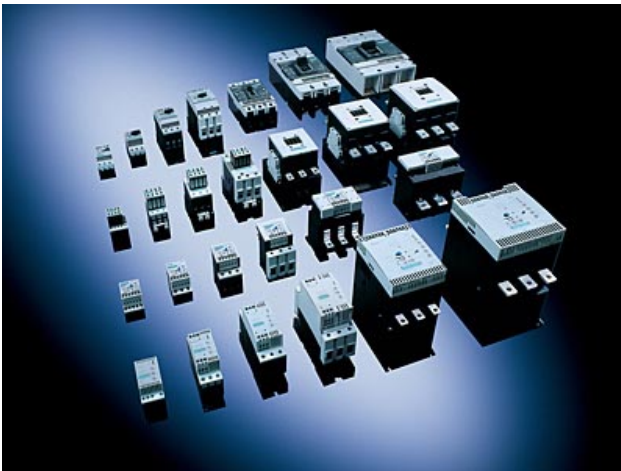

CONTACTOR, 75KW/400V/AC-3,
AC(40...60HZ)/DC OPERATION UC 23...26V AUXIL.
CONTACTS 2NO+2NC 3-POLE,
SIZE S6 BAR CONNECTIONS CONVENTIONAL
OPERATING MECHAN.

General details:

Size of the contactor	S6
Number of poles	3

Control circuit:

Design of activation of the operating mechanism	conventional
---	--------------

Type of voltage	AC/DC
-----------------	-------

Control supply voltage	
• at 50 Hz / for AC / rated value / minimum	23 V
• at 50 Hz / for AC / rated value / maximum	26 V
• at 60 Hz / for AC / rated value / minimum	23 V
• at 60 Hz / for AC / rated value / maximum	26 V
• for DC / rated value / minimum	23 V
• for DC / rated value / maximum	26 V

Supply voltage frequency / for auxiliary and control current circuit / rated value	
• minimum	50 Hz
• maximum	60 Hz

Design of the surge suppressor	with varistor
--------------------------------	---------------

Main circuit:

Number of NC contacts / for main contacts	0
Number of NO contacts / for main contacts	3
Operating current	
• at AC-3 / at 400 V / rated value	150 A
• at AC-1 / at 400 V / rated value	185 A
Service power	
• at AC-3 / at 400 V / rated value	75 kW
• at AC-1 / at 400 V / rated value	105 kW
Auxiliary circuit:	
Identification number and letter for switching elements	22
Number of NO contacts / for auxiliary contact	2
Number of NC contacts / for auxiliary contact	2
Connection type:	
Design of the electrical connection / for main current circuit	screw-type terminals
Design of the electrical connection / for auxiliary and control current circuit	screw-type terminals
Mounting/fixing:	
Type of fixing/fixation	screw fixing
Series installation	Yes

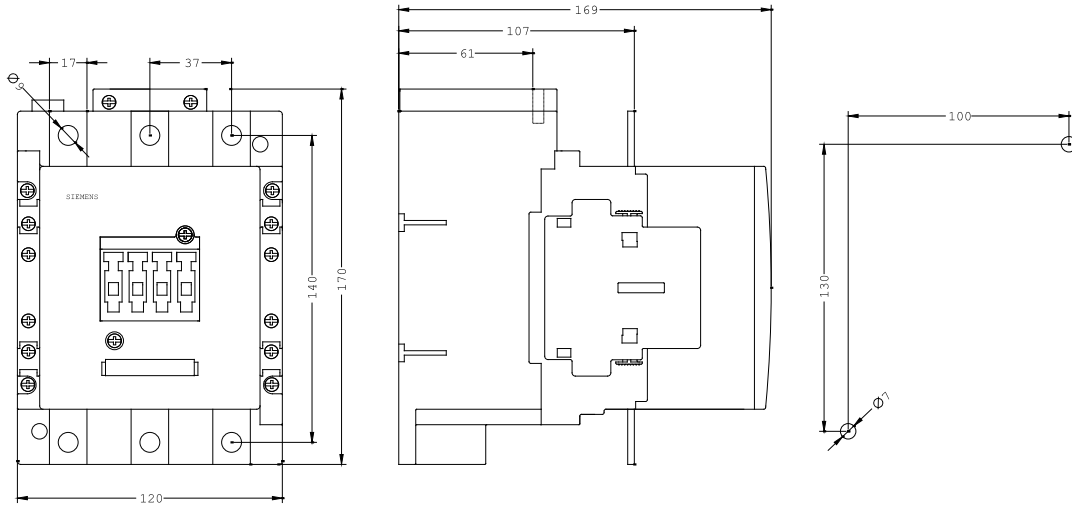

last change:

10/31/2006

Technical Assistance:	Telephone:	+49 (0) 911-895-5900 (8 ⁰⁰ - 17 ⁰⁰ CET)
	Fax:	+49 (0) 911-895-5907
	E-Mail:	technical-assistance@siemens.com
	Internet:	www.siemens.de/lowvoltage/technical-assistance