

# SIEMENS

## Product data sheet

## 3RT1055-6AF36

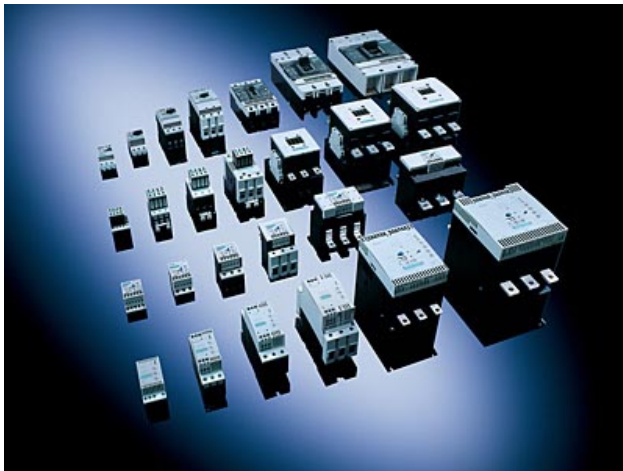

CONTACTOR, 75KW/400V/AC-3,  
AC(40...60HZ)/DC OPERATION UC 110...127V  
AUXIL. CONTACTS 2NO+2NC 3-POLE,  
SIZE S6 BAR CONNECTIONS CONVENTIONAL  
OPERATING MECHAN. SCREW TERMINAL

### General details:

Size of the contactor	S6
Number of poles	3

### Control circuit:

Design of activation of the operating mechanism	conventional
---	--------------

Type of voltage	AC/DC
-----------------	-------

### Control supply voltage

• at 50 Hz / for AC / rated value / minimum	110 V
• at 50 Hz / for AC / rated value / maximum	127 V
• at 60 Hz / for AC / rated value / minimum	110 V
• at 60 Hz / for AC / rated value / maximum	127 V
• for DC / rated value / minimum	110 V
• for DC / rated value / maximum	127 V

### Supply voltage frequency / for auxiliary and control current circuit / rated value

• minimum	50 Hz
• maximum	60 Hz

Design of the surge suppressor	with varistor
--------------------------------	---------------

### Main circuit:

Number of NC contacts / for main contacts	0
Number of NO contacts / for main contacts	3
Operating current	
• at AC-3 / at 400 V / rated value	150 A
• at AC-1 / at 400 V / rated value	185 A
Service power	
• at AC-3 / at 400 V / rated value	75 kW
• at AC-1 / at 400 V / rated value	105 kW
<b>Auxiliary circuit:</b>	
Identification number and letter for switching elements	22
Number of NO contacts / for auxiliary contact	2
Number of NC contacts / for auxiliary contact	2
<b>Connection type:</b>	
Design of the electrical connection / for main current circuit	screw-type terminals
Design of the electrical connection / for auxiliary and control current circuit	screw-type terminals
<b>Mounting/fixing:</b>	
Type of fixing/fixation	screw fixing
Series installation	Yes

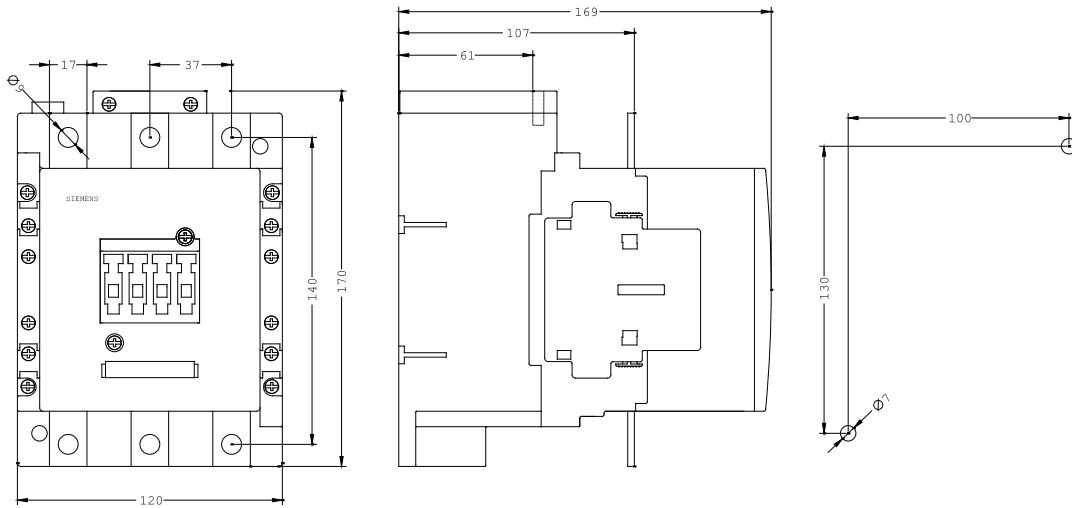

last change:

10/31/2006

<b>Technical Assistance:</b>	Telephone:	+49 (0) 911-895-5900 (8 <sup>00</sup> - 17 <sup>00</sup> CET)
	Fax:	+49 (0) 911-895-5907
	E-Mail:	technical-assistance@siemens.com
	Internet:	www.siemens.de/lowvoltage/technical-assistance